

LED READING LIGHT AND SWITCH - REMOVAL/INSTALLATION**1. General**

- A. The passenger LED reading light removal and installation procedures include reading light and reading light switch removal/installation. There is usually a reading light installed at each aft passenger position.

2. Passenger LED Reading Light Removal/Installation

NOTE: Removal procedures for each of the reading lights are typical.

- A. Remove the LED Passenger Reading Light (Refer to Figure 401).
- (1) Remove external electrical power from the airplane.
 - (2) Make sure that the BATTERY switch (SC005), found on the circuit breaker switch panel, is set to the OFF position.
 - (3) Make sure that the EXTERNAL POWER switch (SC006), found on the circuit breaker switch panel, is set to the OFF position.
 - (4) Disengage the RNDG LIGHT circuit breaker found on the left circuit breaker panel.
 - (5) Open the headliner as necessary to get access to the top of the light assembly. Refer to Chapter 25, Cabin Upholstery.
 - (6) Disconnect the LED light electrical connector from the lighting system wiring harness electrical connector.
 - (7) At the top of the light assembly, remove the mounting nut.
 - (8) Carefully remove the LED light from the overhead panel.
 - (9) Remove the LED light from the airplane.

- B. Install the LED Passenger Reading Light (Refer to Figure 401).

NOTE: Installation procedures for each of the reading lights are typical.

- (1) Carefully put the light in its correct position on the overhead bracket.
- (2) Install the mounting nut at the top of the light assembly.
- (3) Connect the LED light electrical connector to the reading light switch harness electrical connector.
- (4) Close the headliner as necessary. Refer to Chapter 25, Cabin Upholstery.
- (5) Engage the RNDG LIGHT circuit breaker.
- (6) Test the LED reading light as follows:
 - (a) Supply external electrical power on the airplane
 - (b) Set the BATTERY switch found on the circuit breaker switch panel, to the ON position
 - (c) Set the EXTERNAL POWER switch found on the circuit breaker switch panel, to the ON position
 - (d) Push the applicable passenger reading light switch to the ON position
 - (e) Make sure that the reading lights operate correctly
 - (f) Push the passenger reading light switch to the OFF position
 - (g) Set the EXTERNAL POWER switch to the OFF position
 - (h) Set the BATTERY switch to the OFF position
 - (i) Remove external electrical power from the airplane.

3. Passenger Compartment Reading Light Switch Removal/Installation

- A. Remove the passenger compartment reading light switch (Refer to Figure 401).
- (1) Remove external electrical power from the airplane.
 - (2) Make sure that the BATTERY switch (SC005), found on the circuit breaker switch panel, is set to the OFF position.
 - (3) Make sure that the EXTERNAL POWER switch (SC006), found on the circuit breaker switch panel, is set to the OFF position.
 - (4) Disengage the RNDG LIGHT circuit breaker found on the left circuit breaker panel.
 - (5) Carefully pull the pushbutton down from the switch body.
 - (6) Remove the decorative nut, dress ring and cover from the switch.
 - (7) Open the headliner as necessary to get access to the top of the switch assembly. Refer to Chapter 25, Cabin

Upholstery.

- (8) Disconnect the electrical connectors from the light assembly and system wire bundle electrical connectors.
 - (9) Remove the nut and washer that attach the switch to the overhead assembly.
 - (10) Push the switch up out of its mounting hole and remove it from the overhead assembly.
- B. Install the passenger compartment reading light switch (Refer to Figure 401).
- (1) Connect the applicable electrical connector to the light assembly and the system wire bundle electrical connector.
 - (2) Put the switch in its correct position in its mounting hole.
 - (3) Install the nut and washer that attach the switch to the overhead assembly.
 - (4) Install the decorative nut, dress ring and cover on the switch.
 - (5) Close the headliner as necessary. Refer to Chapter 25, Cabin Upholstery.
 - (6) Test the LED reading light switch as follows:
 - (a) Supply external electrical power on the airplane
 - (b) Set the BATTERY switch found on the circuit breaker switch panel, to the ON position
 - (c) Set the EXTERNAL POWER switch found on the circuit breaker switch panel, to the ON position
 - (d) Push the applicable passenger reading light switch to the ON position
 - 1 Make sure that the reading light comes on.
 - (e) Push the passenger reading light switch to the OFF position
 - 1 Make sure that the reading light goes off.
 - (f) Set the EXTERNAL POWER switch to the OFF position
 - (g) Set the BATTERY switch to the OFF position
 - (h) Remove the external electrical power from the airplane.

Figure 401 : Sheet 1 : Passenger LED Reading Lights Installation

A87411

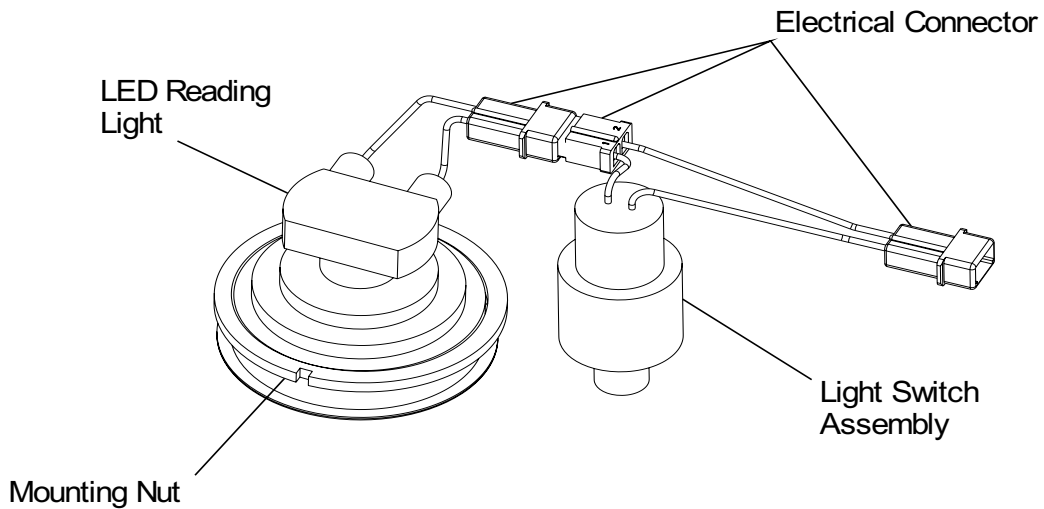
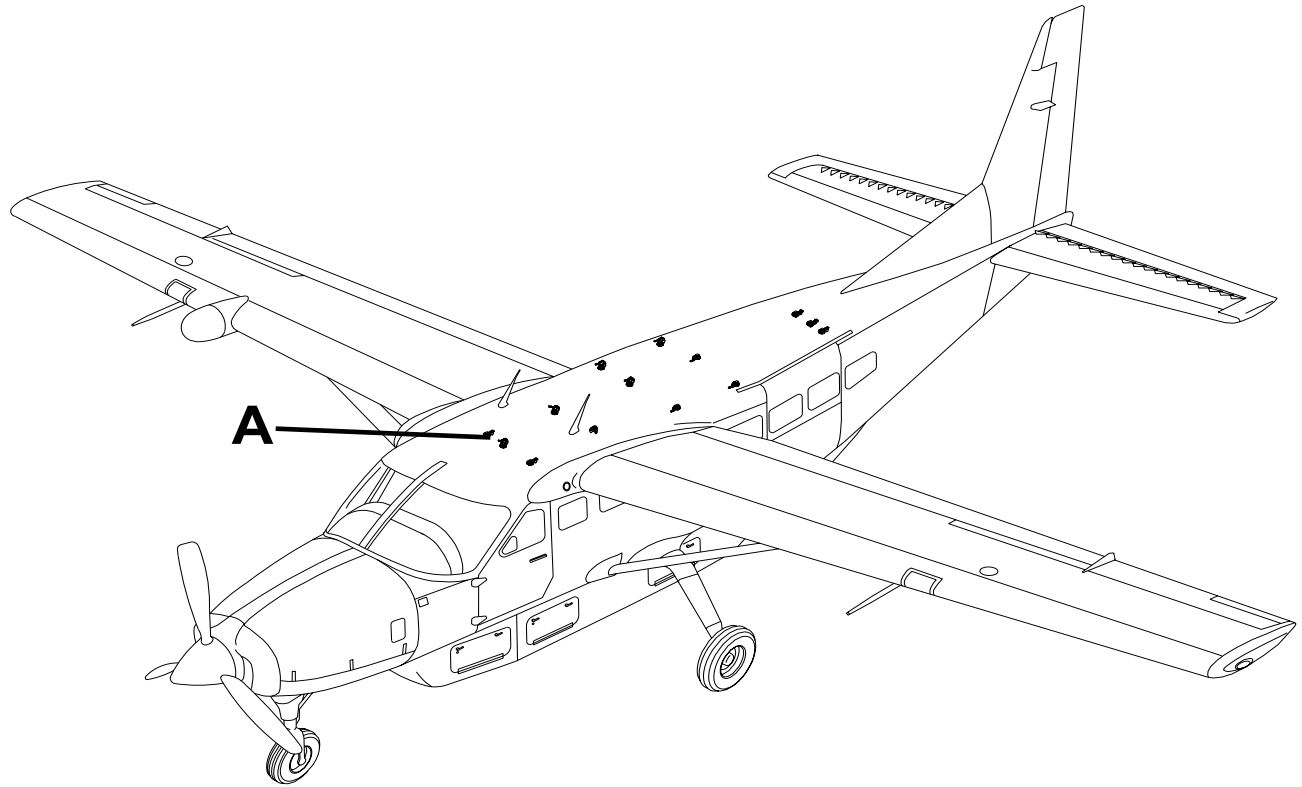

DETAIL A

2610T7004
A2618T1468